

Commercial Dehumidifier

homeLabs™

160 PPD (HME021007N)

140 PPD (HME020437N)

SKU: HME021007N

SKU: HME020437N

Thank you for purchasing our appliance. Please be sure to read the entirety of this user manual carefully prior to using this appliance. If you have any questions regarding the use of this product, please call 1-(800)-898-3002.

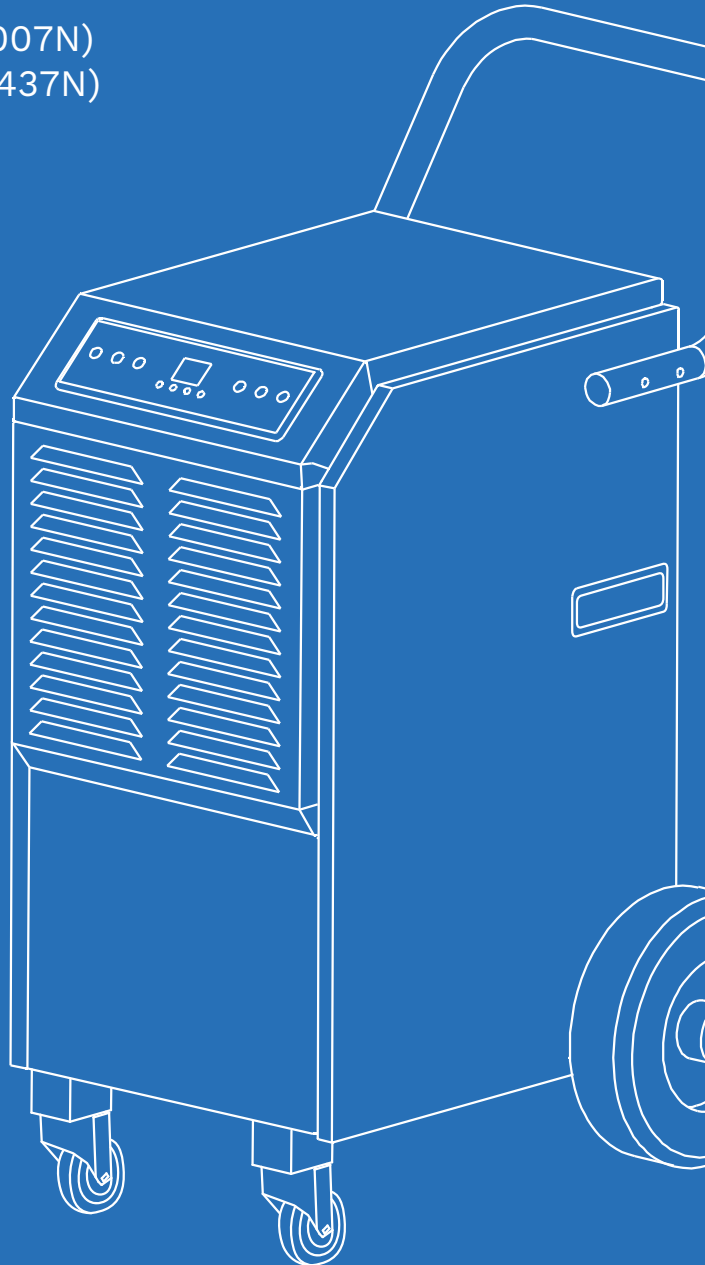



Before First Use

To prevent any internal damage, it is very important to keep the unit upright throughout its journey. Please leave it standing upright and outside the box for **24 HOURS** before plugging it in.

In the event this product malfunctions, or you believe it is defective, please contact Customer Service at homelabs.com/help, or help@homelabs.com and hold onto the defective product (pending further instruction). A defective product should be clearly marked or stored where it cannot be used by mistake. Failure to keep the product in its original quality from the time of receipt may impede hOmeLabs's ability to correct any legitimate problem and may limit the extent to which hOmeLabs may provide recourse.

Table of Contents

Important Safety Instructions	4–6
Installation.....	7–8
Operation.....	9–12
Cleaning and Maintenance.....	12
Specifications.....	13
Troubleshooting.....	14
Warranty.....	15
Manufacturing Info.....	15
Warning.....	15
Contact Us.....	15

Congratulations
on bringing home your new appliance!

Don't forget to register your product at homelabs.com/reg for updates, coupons, and other relevant information.

Although greatly appreciated, product registration is not required to activate any warranty.

IMPORTANT SAFETY INSTRUCTIONS

PRODUCT DESCRIPTION

This dehumidifier removes moisture from interior spaces and is commonly used in basements, warehouses, homes, and other places.

R32 is used as a refrigerant in this unit. R32 is generally considered environmentally benign. Care should be taken when handling or using devices with R32 due to its flammability.

SYMBOLS FROM THE UNIT AND USER MANUAL



CAUTION: Risk of fire/ flammable materials

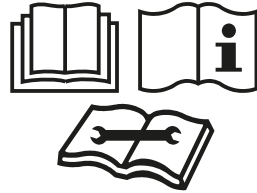

IMPORTANT NOTE: Read this manual carefully before installing or operating your new air conditioning unit. Keep this manual for future reference.

- THE FOLLOWING SHOULD ALWAYS BE OBSERVED FOR SAFETY.
- This appliance is not intended for use by persons (including children with reduced physical, sensory, or mental capabilities or lack of experience and knowledge unless they have been given instruction concerning its use and supervised by a person responsible for their safety or care. Keep out of reach of children under eight (8) years old.
- This appliance is designed for indoor use only. Do not use outdoors.
- The unit is designed only for use with R32 (propane) gas as the designated refrigerant. The propane gas used in the unit has no odor. The lack of smell does not indicate a lack of escaped gas.
- The refrigerant loop is sealed. Only a qualified technician should attempt to service!
- Do not discharge the refrigerant into the atmosphere.
- R32 (propane) is flammable. The propane gas used in the unit has no odor.
- If propane gas is present or even suspected, immediately open windows or ventilate the room. Do not turn on or activate the unit if the unit is off. If the unit is on, immediately terminate use of the unit. Do not allow untrained personnel to attempt to find the cause. Do not allow untrained personnel to attempt to find the cause.
- Do not let any persons back into the room until the qualified service technician has arrived and that technician advises that it is safe to return to the room.
- No open flames, cigarettes or other possible sources of ignition should be used inside or in the vicinity of the units.
- Component parts are designed for propane and non-incentive and non-sparking. Component parts shall only be replaced with identical repair parts.
- FAILURE TO ABIDE BY THIS WARNING COULD RESULT IN AN EXPLOSION, DEATH, INJURY AND PROPERTY DAMAGE.

FOR YOUR SAFETY

WARNING:

Please read this manual carefully and fully understand before operating your appliance.

- If the supply cord is damaged, it must be replaced by the manufacturer, its service agent or similarly qualified persons in order to avoid a hazard.
- The appliance shall be disconnected from its power source during service.

- Always operate the unit from a power source of equal voltage, frequency and rating as indicated on the product identification plate.
- Always use a power outlet that is grounded.
- Unplug the power cord when cleaning or when not in use.
- Do not operate with wet hands. Prevent water from spilling onto the unit.
- Do not immerse or expose the unit to rain, moisture or any other liquid.
- Do not leave the unit running unattended. Do not tilt or turn over the unit.
- Do not unplug while the unit is operating.
- Do not unplug by pulling on the power cord.
- Do not use an extension cord or an adapter plug.
- Do not put objects on the unit.
- Do not climb or sit on the unit.
- Do not insert fingers or other objects into the air outlet.
- Do not touch the air inlet or the aluminum fins of the unit.
- Do not operate the unit if it is dropped, damaged or showing signs of product malfunction.
- Do not clean the appliance with any chemicals.
- Ensure the unit is far away from fire, inflammable, or explosive objects.
- Ensure unit is installed in accordance with national wiring regulations the unit.
- Do not use any means to accelerate the defrosting process or to clean.
- The appliance shall be stored in a room without continuous heat sources (for example: open flames, an operating gas appliance or an operating electric heater).
- Securely store the unit when not in use so as to prevent mechanical damage from occurring.
- Do not pierce or burn, even after use.
- If you suspect a leak has occurred, immediately vent the room and contact your local fire department.
- Be aware that refrigerants may not contain an odour.
- Pipe-work shall be protected from physical damage and shall not be installed in an unventilated space, if that space is smaller than 4 m².
- Compliance with national gas regulations shall be observed.
- Keep any required ventilation openings clear of obstruction.
- Store appliance in well-ventilated area where the room size corresponds to the room area specified for operation.

WARNING:

Any person who is involved with working on or breaking into a refrigerant circuit should hold a current valid certificate from an industry-accredited assessment authority, which authorizes their competence to handle refrigerants safely in accordance with an industry, recognized assessment specification.

Servicing shall only be performed as recommended by the equipment manufacturer. Maintenance and repair requiring the assistance of other skilled personnel shall be carried out under the supervision of the person competent in the use of flammable refrigerants.

1. SAFETY PRECAUTIONS ON SERVICING

Please follow these warnings when to undertake the following when servicing an appliance with R32.

2. CHECKS TO THE AREA

Prior to beginning work on systems containing flammable refrigerants, safety checks are necessary to ensure that the risk of ignition is minimized. For repair to the refrigerating system, the following precautions shall be complied with prior to conducting work on the system.

3. WORK PROCEDURE

Work shall be undertaken under a controlled procedure so as to minimize the risk of a flammable gas or vapor being present while the work is being performed.

4. GENERAL WORK AREA

All maintenance staff and others working in the local area shall be instructed on the nature of work being carried out. Work in confined spaces shall be avoided. The area around the work space shall be sectioned off. Ensure that the conditions within the area have been made safe by control of flammable material.

5. CHECKING FOR PRESENCE OF REFRIGERANT

The area shall be checked with an appropriate refrigerant detector prior to and during work, to ensure the technician is aware of potentially flammable atmospheres. Ensure that the leak detection equipment being used is suitable for use with flammable refrigerants, i.e. no sparking, adequately sealed or intrinsically safe.

6. PRESENCE OF FIRE EXTINGUISHER

If any hot work is to be conducted on the refrigeration equipment or any associated parts, appropriate fire extinguishing equipment shall be available to hand. Have a dry powder or CO2 fire extinguisher adjacent to the charging area.

7. NO IGNITION SOURCES

No person carrying out work in relation to a refrigeration system which involves exposing any pipe work that contains or has contained flammable refrigerant shall use any sources of ignition in such a manner that it may lead to the risk of fire or explosion. All possible ignition sources, including cigarette smoking, should be kept sufficiently far away from the site of installation, repairing, removing and disposal, during which flammable refrigerant can possibly be released to the surrounding space. Prior to work taking place, the area around the equipment is to be surveyed to make sure that there are no flammable hazards or ignition risks. "No Smoking" signs shall be displayed.

8. VENTILATED AREA

Ensure that the area is in the open or that it is adequately ventilated before breaking into the system or conducting any hot work. A degree of ventilation shall continue during the period that the work is carried out. The ventilation should safely disperse any released refrigerant and preferably expel it externally into the atmosphere.

9. CHECKS TO THE REFRIGERATION EQUIPMENT

Where electrical components are being changed, they shall be fit for the purpose and to the correct specification. At all times the manufacturer's maintenance and service guidelines shall be followed. If in doubt consult the manufacturer's technical department for assistance. The following checks shall be applied to installations using flammable refrigerants:

- The charge size is in accordance with the room size within which the refrigerant containing parts are installed;
- The ventilation machinery and outlets are operating adequately and are not obstructed;
- If an indirect refrigerating circuit is being used, the secondary circuit shall be checked for the presence of refrigerant;
- Marking to the equipment continues to be visible and legible. Markings and signs that are illegible shall be corrected;
- Refrigeration pipe or components are installed in a position where they are unlikely to be exposed to any substance which may corrode refrigerant containing components, unless the components are constructed of materials which are inherently resistant to being corroded or are suitably protected against being so corroded.

10. CHECKS TO ELECTRICAL DEVICES

Repair and maintenance to electrical components shall include initial safety checks and component inspection procedures. If a fault exists that could compromise safety, then no electrical supply shall be connected to the circuit until it is satisfactorily dealt with. If the fault cannot be corrected immediately but it is necessary to continue operation, an adequate temporary solution shall be used. This shall be reported to the owner of the equipment so all parties are advised. Initial safety checks shall include:

- Those capacitors are discharged: this shall be done in a safe manner to avoid possibility of sparking;
- That there no live electrical components and wiring are exposed while charging, recovering or purging the system;
- That there is continuity of earth bonding.

WARNING:

Install the unit in rooms which exceed 4 m². Do not install the unit in a place where inflammable gas may leak.

NOTE: The manufacture may provide other suitable example or may provide additional information about the refrigerant odour.

SAVE THESE INSTRUCTIONS

Installation

ACCESSORIES

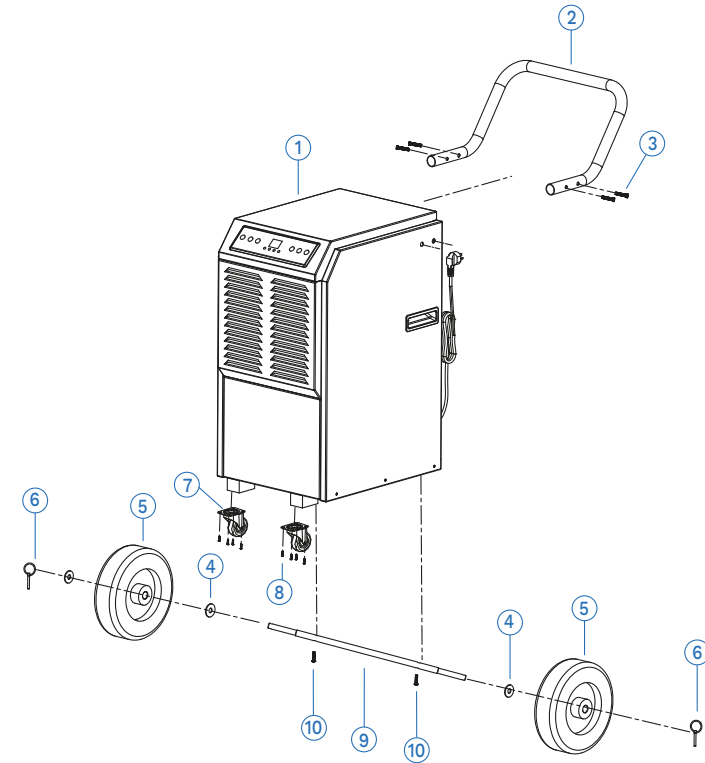

PARTS NAME	DIMENSIONS	QUANTITY
1. Main Body		
2. Handle		
3. Screw	6 × 35 mm	4 pcs (2 spare)
4. Washer	13 × 24 × 3 mm	2 pcs (4 spare)
5. Wheel		2 pcs
6. Locating Pin		2 pcs
7. Caster		2 pcs
8. Screw	4 × 10 mm	8 pcs (4 spare)
9. Axle		
10. Screw	M6 × 25 mm	2 pcs (1 spare)

NOTE: READ BEFORE FIRST USE (See page 5) before following these steps.

Attach the Handle

1. Place the device on its front side.
2. Mount the Handle (2) to the device sides using Screws (3). The hole sites must be aligned on both sides.

Mounting the Casters

1. Lay down the unit by pulling the Handle backward. This will reveal the appliance's bottom.
2. Fix the two Casters (7) with Screws (8) to the two brackets on the appliance's bottom by using a screwdriver (we recommend electric). Each Caster. Each Caster should be installed using four Screws.

Mounting the Wheels

1. Place the device on its front side.
2. Attach an Axle (9) with 2 Screws (10) to the bottom of the device by using a screwdriver
3. Add a Washer (4) onto the Axle.
4. Mount a Wheel (5) in front of the Washer.
5. Use a Locating Pin (6) to secure the Wheel (5) on the Axle.
6. Repeat steps 2 to 5 to install the Axle on the other side.
7. After mounting the Casters and the Wheels, place the device in an upright position.

Install the Drain Hose

Attach the supplied Drain Hose to the Drainage Port on the appliance. Direct the Hose to the desired area before operating the appliance.

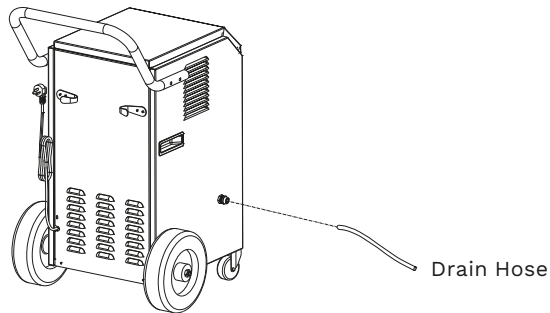

- If the drain area is located above the Dehumidifier, the maximum capacity of the water pump is 16.4 ft (5 m). If the water is drained downwards, there is no limit for the distance.

WARNING:

Do not block the Drain Hose. The end of the Drain Hose should not be higher than the outlet hole. If the end of the Drain Hose is higher than the outlet hole, water will not drain properly and could damage the components of the unit.

PARTS OVERVIEW

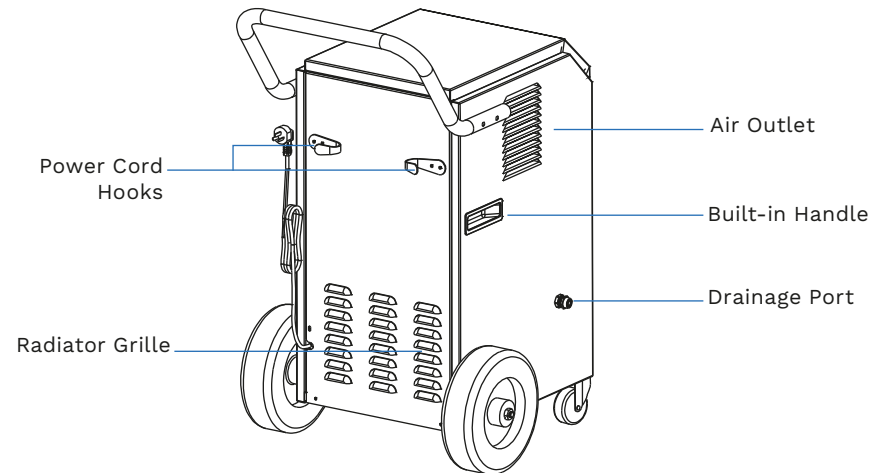
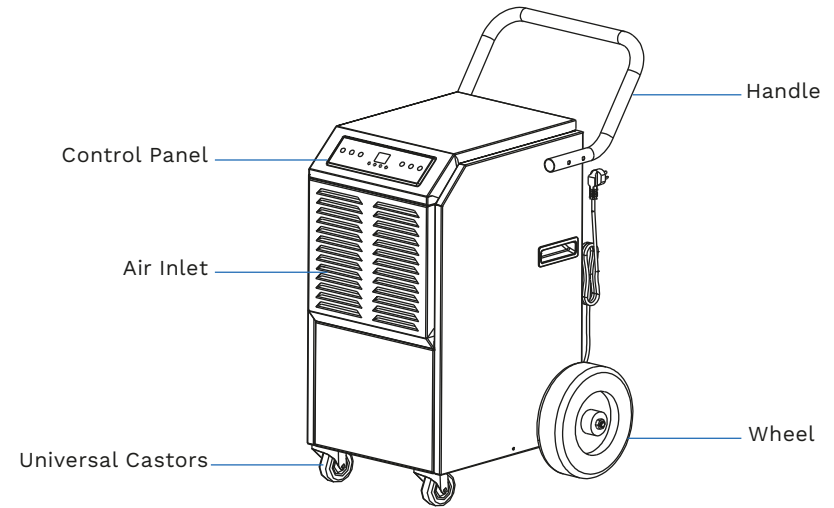

POSITIONING THE APPLIANCE

- This unit may have been tilted or placed upside down during shipping. To ensure this device works properly, please stand this unit upright for at least 24 hours before initial use.
- This Dehumidifier is designed to operate with a working environment between 41°F (5°C) and 90°F (32°C).

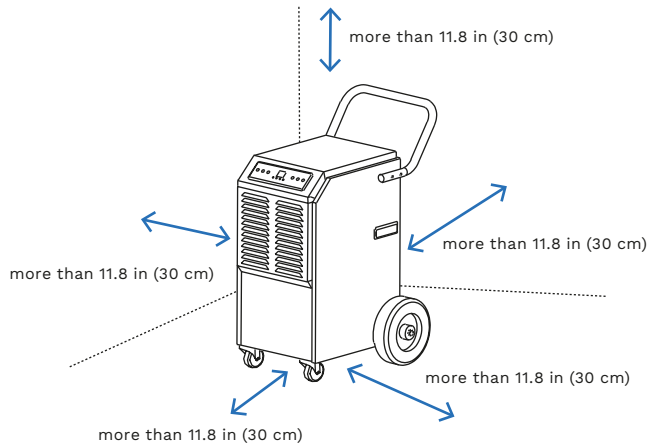

CONTROL PANEL

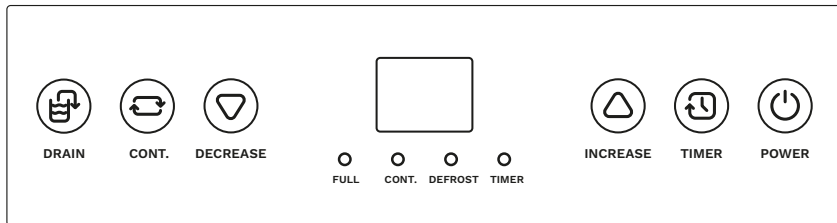

To Turn On/Off the Appliance

- Plug in the appliance, the screen will light up. Press the “Power” button. The unit will start working in continuous mode. The screen displays the room humidity. The Compressor will start to work 3 seconds after the Fan starts working.
- To turn off the appliance, press the “Power” button. The screen displays the room humidity and the appliance goes into standby mode. The Fan will run for another minute before stopping.

Adjusting the Timer

- Auto On: Press “Timer” button while the appliance is off. The “Timer” indicator will light up. Press “Increase / Decrease” button to set the time you want to start the appliance. When the countdown is over, the Fan and the Compressor will turn on.
- Auto Off: Press “Timer” button while the appliance is running until the “Timer” indicator lights up. Press “Increase / Decrease” button to set the time you want the appliance to turn off. When the countdown is over, the Fan and Compressor will shut off.
- To display the current temperature, press and hold “Timer” button for 3 seconds. After 10 seconds, the screen will display current humidity.

To Set the Humidity Level

The default set humidity level is 50% RH. To adjust the humidity level, press and hold the “Increase” or “Decrease” button. The humidity level can be increased or decreased by increments of 5% RH in normal mode.

NOTE:

Room humidity and appliance set humidity will determine the status of the Compressor and Fan, as follows:

- If the room humidity \geq appliance set humidity + 3%, the Compressor and the Fan will start running.
- If the room humidity $<$ appliance set humidity - 3%, the Compressor and the Fan will stop running.

To Use the Continuous Mode

In continuous mode, humidity setting is invalid. The continuous mode indicator turns on and the screen will display the current humidity. To exit the continuous mode, press “Cont.” button. The humidity setting is resumed.

Water Drainage

- When the Water Tank is full, the Water Pump will start automatically. The “Full” indicator will illuminate red. After 35 seconds, the Water Pump will stop and the “Full” indicator will turn off.
- To drain the water manually, press and hold the “Drain” button. This works even when the tank does not indicate “Full”. The Water Pump will operate for 35 seconds before stopping. Repeat until all water is drained.
- The “Full” indicator will turn on and off according to the Water Pump status.

NOTE: Drain the water manually before storing or moving the unit.

Operation

- The system has auto memory. If there is a sudden power loss during operation, the system restores the last settings before the power loss and will resume operation when powered on.

Defrost Function

- The appliance will defrost automatically when it is operating at low temperatures. Compressor and the Fan will shut off if the environmental temperature is below 41°F or above 100.4°F.
- After the Compressor runs for 30 minutes, the temperature sensor will detect the copper pipe temperature. When the detected temperature is $\leq 30.2^\circ\text{F}$ in the last 10 seconds, the Compressor will stop and start to defrost. The Fan will keep working and the “Defrost” indicator will turn on. When the pipe temperature reaches 41°F or the defrost lasts for 15 minutes, the appliance quits the defrosting.

NOTE: During the defrosting, the indicator light will remain lit until the defrosting is over.

Error Codes

In case of malfunction, the appliance will display an error code.

E1 – Temperature sensor issue. The system will work in cycles of dehumidification for 30 minutes and defrosting for 15 minutes. The temperature sensor needs to be replaced. Please call Customer Service for further support.

E2 – Humidity sensor issue. The humidity adjusting button will not work. The system will work in cycles of dehumidification for 30 minutes and defrosting for 15 minutes. The humidity sensor needs to be replaced. Please call Customer Service for further support.

Operation

Protection Codes

FL - The water full switch sensor failed or the Water Pump failed.

NOTE: When one of the above malfunctions occurs, turn off the Dehumidifier, and check for any obstructions. Restart the Dehumidifier, if the malfunction is still present, turn off the Dehumidifier and unplug the power cord. Contact Customer Service for repair and/or replacement.

Cleaning and Maintenance

- Clean the appliance exterior with a soft wet cloth.

Clean the Filter

- Pull the louver on the front panel out to gain access to the Filter.

- Remove the Filter.
- Use a clean rag to absorb the surface dust on the Filter. If the Filter is extremely dirty, use potable tap water to flush it. Fully dry the Filter before putting it into the Air Inlet panel. A clean Filter will increase the appliance's efficiency.
- Clean the Filter with potable water at least once every 30 days.

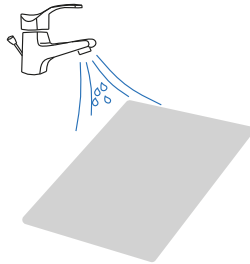
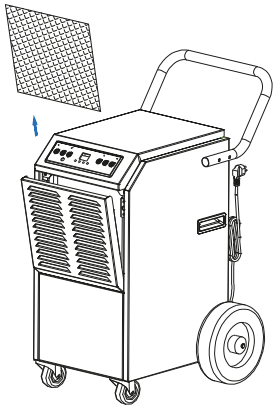

Storage Requirements

If the unit will remain unused for an extended period of time, follow steps below:

- Clean the Filter.
- **ATTENTION! The evaporator inside the appliance has to be dried out before the unit is packed to avoid component damage. Unplug the unit and place it in a dry open area for several days to dry it out.**
- Store the power cord on the Power Cord Hooks at the back of unit.
- Cover the Dehumidifier with a plastic bag or a tarp.
- Store the Dehumidifier upright in a dry, well-ventilated location.

Specifications

Voltage & Frequency	AC 115 V, 60 Hz
Rated Capacity	45 Pints / Day @ 65°F, 60% RH
	70 Pints / Day @ 80°F, 60% RH
	120 Pints / Day @ 86°F, 80% RH
	160 Pints / Day @ 95°F, 90% RH
Power Consumption & Current	532 W / 4.7 A @ 65°F, 60% RH
	660 W / 5.8 A @ 80°F, 60% RH
	780 W / 6.8 A @ 86°F, 80% RH
	930 W / 8.1 A @ 95°F, 90% RH
Noise	≤60 dB(A)
Air Circulation	265 CFM
Refrigerant Type & Capacity	R32 / 6.71 oz
Minimum Current of Power Supply	15 A
Maximum Design Pressure	High Side: 550 psig
	Low Side: 260 psig
Compressor Input	RLA: 5.5 A LRA: 27 A
Fan Motor Power	0.100 HP

PROBLEM	CAUSE	SOLUTION
The appliance does not run	<ul style="list-style-type: none"> The Dehumidifier is not plugged in securely. A fuse blew or a circuit breaker tripped. 	<ul style="list-style-type: none"> Make sure the Dehumidifier's plug is inserted completely into the outlet. Replace with a new fuse or reduce power-consuming devices.
	The room temperature is under 41°F or above 100.4°F.	To protect the appliance, use it only when the ambient temperature is between 41°F and 100.4°F.
The appliance runs but does not dehumidify	<ul style="list-style-type: none"> Did not allow enough time to remove the moisture. The humidity level may not be set low enough. Doors, windows or other openings were left ajar/open. There is a kerosene heater or another appliance producing water vapor in the room. 	<ul style="list-style-type: none"> Allow enough time to remove the moisture. Reset the humidity level. Check that all doors, windows and other openings are securely closed. Remove the objects giving off water vapor in the room.
Reduced Dehumidifier capacity	The filter mesh is jammed.	Clean the filter mesh.
	The air-in and/or air-out louvers are jammed.	Clear the blockage from the air-in and air-out louvers.
No air inlet	The filter mesh or air-in louver is jammed.	Clean the filter or the louver blockage.
Loud aspirating noise	The appliance is placed on an incline or decline slope.	Move the appliance to flat ground.
	The filter mesh is jammed.	Clean the filter mesh.
Water on the floor	<ul style="list-style-type: none"> Hose to connector or Hose connection may be loose. Hose is kinked. 	<ul style="list-style-type: none"> Reconnect the Hose securely. Fix the Hose.

hOmeLabs offers a limited one-year warranty (“warranty period”) on all of our products purchased new and unused from hOmeLabs Technologies, LLC or an authorized reseller, with an original proof of purchase and where a defect has arisen, wholly or substantially, as a result of faulty manufacture, parts or workmanship during one-year warranty period. The warranty does not apply where damage is caused by other factors, including without limitation: (a) normal wear and tear; (b) abuse, mishandling, accident, or failure to follow operating instructions; (c) exposure to liquid or infiltration of foreign particles; (d) servicing or modifications of the product other than by hOmeLabs.

The hOmeLabs warranty covers all costs related to restoring the proven defective product through repair or replacement of any defective part and necessary labor so that it conforms to its original specifications. A replacement product may be provided instead of repairing a defective product. hOmeLabs exclusive obligation under this warranty is limited to such repair or replacement.

A receipt indicating the purchase date is required for any claim, so please keep all receipts in a safe place. We recommend that you register your product on our website, homelabs.com/reg. Although greatly appreciated, the product registration is not required to activate any warranty and product registration does not eliminate the need for the original proof of purchase. The warranty becomes void if attempts at repair are made by non-authorized third parties and/or if spare parts, other than those provided by hOmeLabs, are used. You may also arrange for service after the warranty expires at an additional cost.

These are our general terms for warranty service, but we always urge our customers to reach out to us with any issue, regardless of warranty terms. If you have an issue with a hOmeLabs product, please contact us at 1-(800)-898-300, and we will do our best to resolve it for you.

This warranty gives you specific legal rights, and you may have other legal rights which vary from state to state, country to country or province to province. The customer may assert any such rights at their sole discretion.

Manufacturing Info

This manual is to be used with all items with the model number

HME021007N, HME020437N

All R32 refrigerant related matters apply only to the model HME021007N.

Voltage: AC 115 V, 60 Hz

WARNING:
Keep all plastic bags away from children.

Manufacturer, distributor, importer and seller are not liable for ANY damage caused by improper use, storage, care or failure to follow warnings associated with this product.

Contact Us

CHAT WITH US

homelabs.com/help

EMAIL US

help@homelabs.com



Distributed by hOmeLabs™, LLC
37 East 18 Street, 7th Floor
New York, USA 10003

help@homelabs.com
homelabs.com/help

All rights reserved, hOmeLabs™
Made in China.